

Besides maximum flow of 1.250 NI/min at compact design there are 11 more competitive advantages of the Hafner valve series 701.

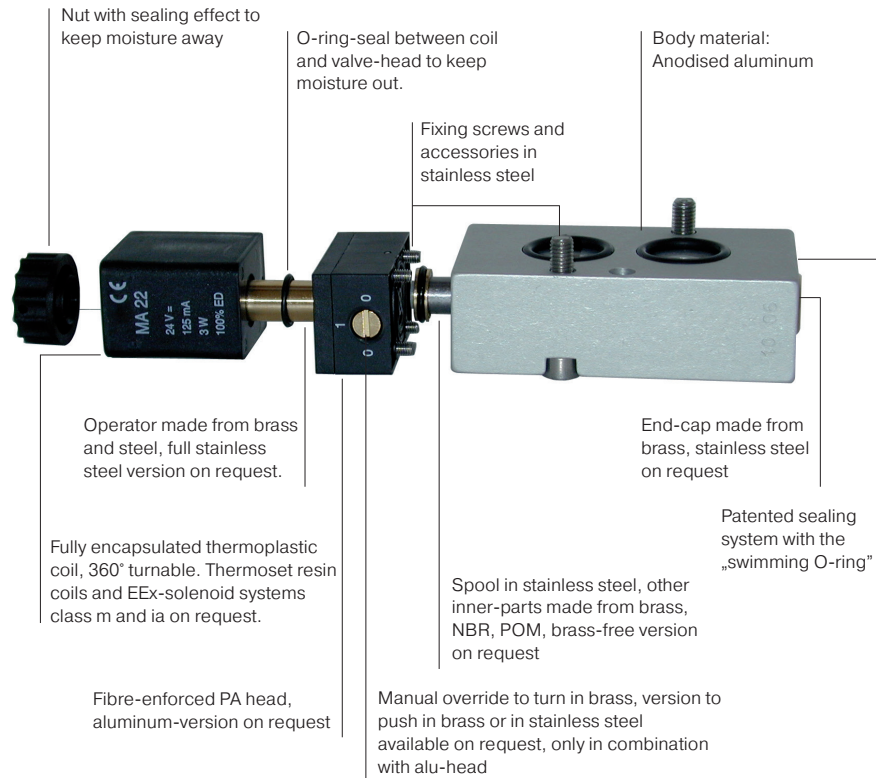

Different customers have demand for different manual overrides. Hafner offers a standard but on demand variations are an option.



Series MH

Manual override to turn by screw driver:

- Direct acting valves
- 22+ mm wide valves (by default)

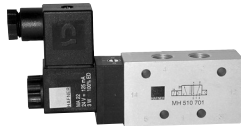

Series MD

Manual override to push, momentary:

- Direct acting valves
- 16 mm wide valves (by default)
- 22+ mm wide valves



Series MF

Manual override to turn by hand:

- Direct acting valves
- 22+ mm wide valves



Series MHF

Manual override to turn by hand and recess for screw-driver use:

- Direct acting valves
- 22+ mm wide valves



16 mm

Series MHD

Manual override to push plus detent position by turning:

- Direct acting valves
- 16 mm wide valves
- 22+ mm wide valves

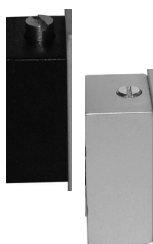

22+ mm

M-Version

Without manual override:

- An option for all 22 mm + wide valves

